



Florida Department of Transportation

RON DESANTIS
GOVERNOR

605 Suwannee Street
Tallahassee, FL 32399-0450

KEVIN J. THIBAUT, P.E.
SECRETARY

For Immediate Release
May 10, 2019

Contact: Hampton Ray
(386) 269-3607
Hampton.Ray@dot.state.fl.us

Travel Advisory: State Road 200 Lane Closure Schedule

Yulee, Fla. – This advisory is to inform community leaders and interested parties about upcoming, scheduled lane closures, traffic shifts and other construction activity on State Road 200/A1A.

The Florida Department of Transportation (FDOT) has permitted multiple lane closures as part of the State Road 200/A1A (S.R. 200) improvement projects. Below are several planned lane closures, weather permitting, from May 11 through May 17, certain activities may require unexpected lane closures for the safety of both drivers and construction workers.

Notable: A traffic shift on Chester Road at S.R. 200 will occur on Saturday, May 11. Additional details are below, and a map is enclosed for convenience. The shift is expected to be in place for several months as crews work to install new drainage and widen the existing roadway.

Daytime lane closures:

Interstate 95:

- The inside travel lane of Interstate 95 near exit 373 is expected to be closed daily, from 9 a.m. until 3:30 p.m. Monday, May 13 through Thursday, May 16. The interstate ramps will not be impacted.

Chester Road:

- On Saturday, May 11, southbound Chester Road traffic will be shifted to the inside of the roadway, so crews can work on the west, outside shoulder of Chester Road behind barrier wall (map enclosed). The shift will reduce the traffic que for motorists turning on S.R. 200 or continuing straight on to Amelia Concourse. The traffic shift is necessary for the safety of construction crews and the public. It is expected to be in place for several months. On Saturday, May 11, the north and southbound lanes of Chester Road will be closed intermittently between 7 a.m. and 6 p.m. during the traffic shift.

Nighttime lane closures:

Interstate 95:

- Northbound Interstate 95 lane closures are expected near exit 373 nightly, Sunday, May 12 through Thursday, May 16 from 7 p.m. to 5:30 a.m. This work is associated with pipe installation. Note: this work may require a multi-lane closure on Interstate 95. No ramps will be impacted.

State Road 200:

- S.R. 200 westbound right lane from Harry Green Road to Yanie Road will take place nightly from 9 p.m. until 6 a.m. beginning Monday, May 13 through Wednesday, May 15.
- S.R. 200 eastbound left turn lane onto Felmor Road will be closed nightly Tuesday, May 14 and Wednesday, May 15 from 9 p.m. until 6 a.m.
- S.R. 200 westbound right turn lane from Eric Oliver Way to Meadowfield Bluffs Road will be closed nightly from 9 p.m. until 6 a.m. on Thursday, May 16 and again on Friday, May 17.
- S.R. 200 eastbound left turn lane onto Gene Lasserre Boulevard will be closed Friday, May 17 from 9 p.m. until 6 a.m.

Felmor Road:

- Southbound Felmor Road right turn lane will be closed Monday, May 13 from 9 p.m. until 6 a.m.
- Southbound Felmor Road left turn lane onto S.R. 200 will be closed the Tuesday, May 14 from 9 p.m. until 6 a.m.
- Northbound lane of Felmor Road will be closed Wednesday, May 15 from 9 p.m. until 6 a.m.

Gene Lasserre Boulevard:

- Southbound right turn lane of Gene Lasserre Boulevard will be closed Thursday, May 16 and again Friday, May 17 from 9 p.m. until 6 a.m.

Throughout construction, drivers are encouraged to plan ahead, use caution and follow the speed limit. Construction is a temporary inconvenience toward a more permanent transportation solution.

For additional information about this project, contact Hampton Ray at: Hampton.Ray@dot.state.fl.us or call: 904-831-FDOT (3368).

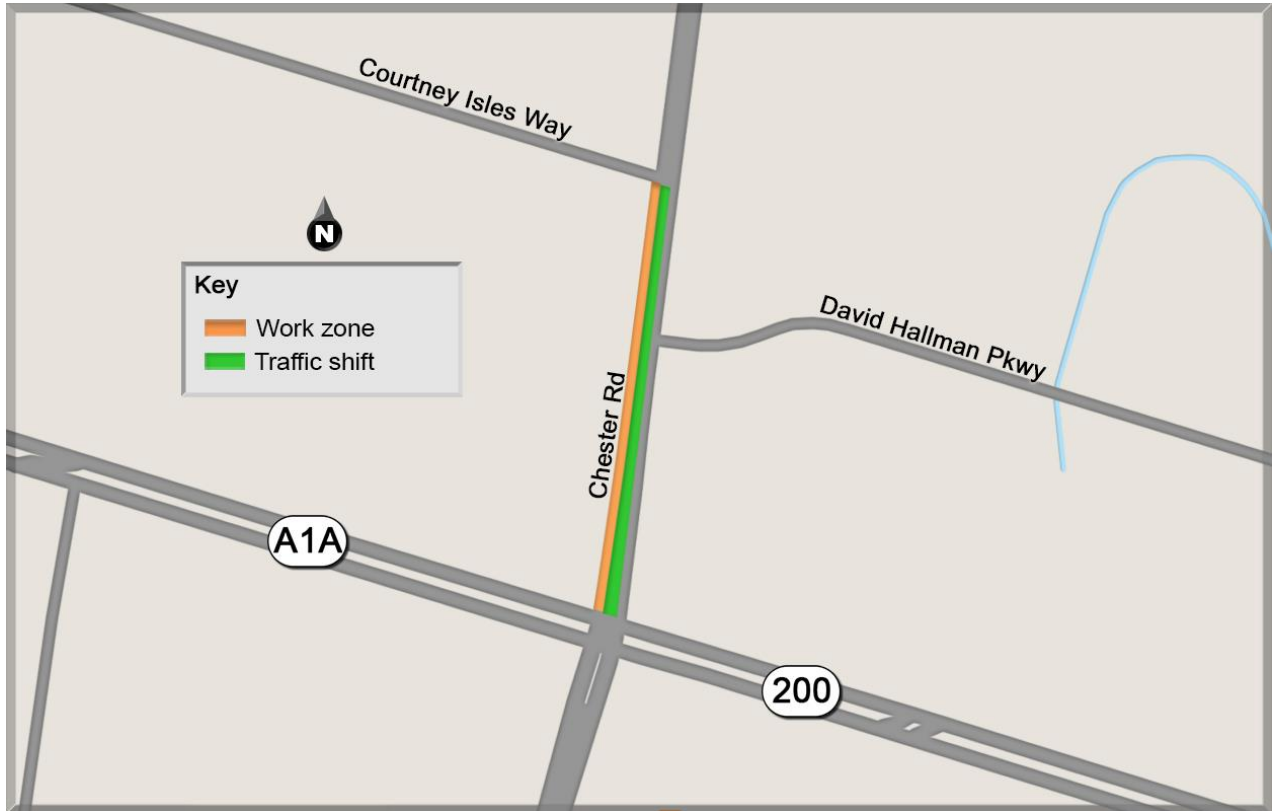

A traffic shift on Chester Road at S.R. 200 is expected to take place on Saturday, May 11, weather and schedule permitting.

###

Florida Department of Transportation